

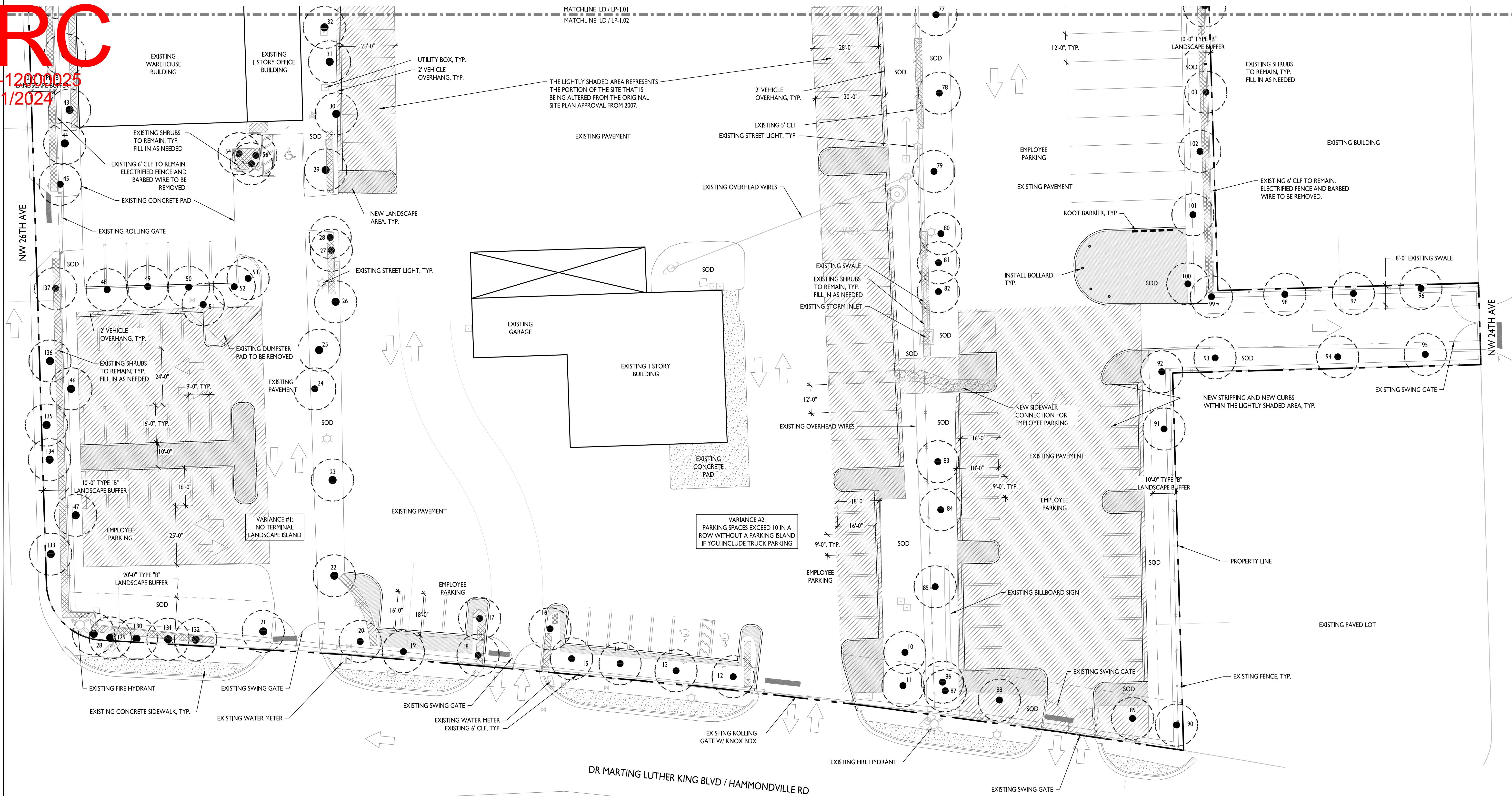

DRC
PZ23-1200025
08/21/2024

Emmanuel Moran \\wgl.com\data\Projects\34051\441302 2025 Martin Luther King Blvd Pompano\LA\Drawings\Landscapes\441302-LA.dwg Plotfile: 6/21/2024 10:46:28 AM Sheet: 6/21/2024 10:42:37 AM

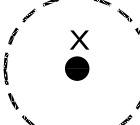
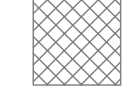

LEGEND

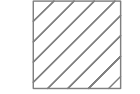
-  PRESERVED TREE / PALM
-  EXISTING SHRUB AREAS TO REMAIN
-  NEW LANDSCAPE AREA
-  THE PORTION OF THE SITE THAT IS BEING ALTERED FROM THE ORIGINAL SITE PLAN APPROVAL FROM 2007

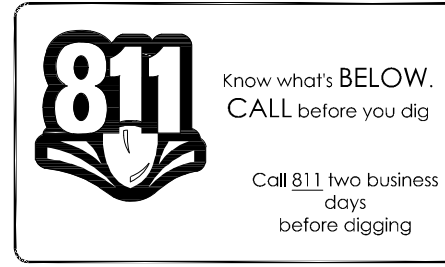
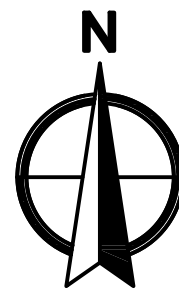
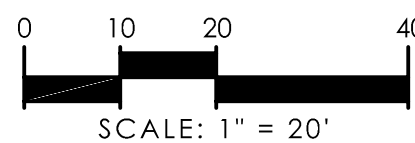

COASTAL RECYCLING OF POMPAO

2407 HAMMONDVILLE ROAD
POMPAO BEACH, BROWARD COUNTY, FLORIDA

TREE DISPOSITION PLAN

SHEET:
LD-1.02

REVISIONS

NO.	DATE	DESCRIPTION	BY	DN
1	11.07.23	RESUBMITTAL	DN	
2	06.21.24	RESUBMITTAL	SW	

CAD 941300-ADWG	JOB NO. 9413.00	DRAWN BY DN	CHECK BY SW	DATE 06.13.2023
LANDSCAPE ARCHITECT OF RECORD SIYANG WEN, PLA FL # LA6667556				



NOT AUTHORIZED
FOR CONSTRUCTION
PRIOR TO FORMAL
CITY APPROVAL



2035 Ysla Parkway, West Palm Beach, FL 33411
Phone No. 866.909.2220 www.wglnc.com
Cert No. 6091 - LB No. 7055